

Scale of 20 chains per inch  
 Georgia Jefferson County  
 Warrant dated June 3<sup>rd</sup> 1834  
 Surveyed 27<sup>th</sup> May 1836

By J. Hudson & G.

Advertised May 25<sup>th</sup> 1836

Thomas Gray }  
 Wm D Stone } C. C.

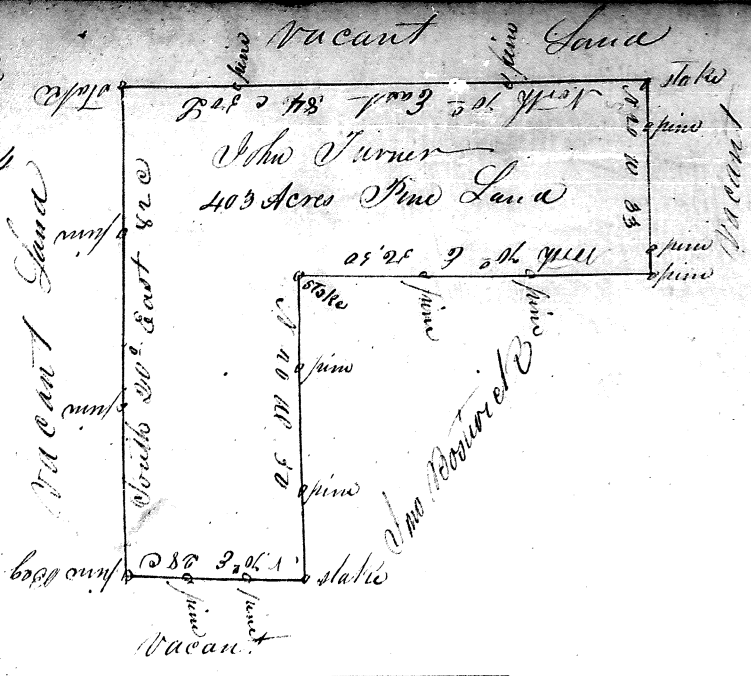

Scale of 20 chains per inch  
 Georgia Jefferson County

Warrant dated Oct 7<sup>th</sup> 1834  
 Surveyed on the 30<sup>th</sup> March 1836

By E. J. Hudson & G.

Advertised April 8<sup>th</sup> 1836  
 E. J. Holt }  
 Henry Greene } C. C.

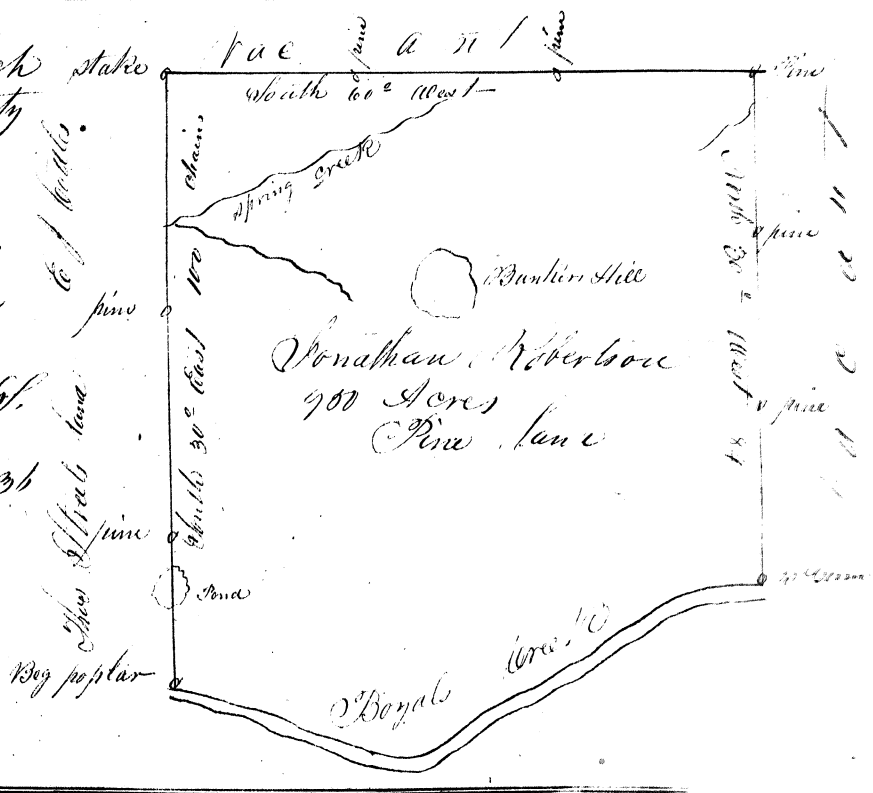

Scale of 20 chains per inch  
 Georgia Walton County  
 Warrant dated Oct 6<sup>th</sup> 1835  
 Surveyed Feb 10<sup>th</sup> 1836

By J. L. Davis C. C.  
 Advertised Sep 22<sup>nd</sup> 1836  
 James Johnston }  
 J. Johnston } C. C.

