

Georgia Lincoln County

Warrant dated 5th August 1834
 Surveyed 7th day August 1834
 By Thomas P. Ashmore J.L.C.
 Advertised 7th day of August
 1834

John Knox
 James Kinney

Scale of 20 Chains to an Inch



Georgia Lincoln County

Warrant dated 4th day February
 1834
 Surveyed 15th Feb: 1834
 Advertised 16th Feb: 1834
 Thomas P. Ashmore J.L.C.

Abram Wallace
 Mitchell Chambers

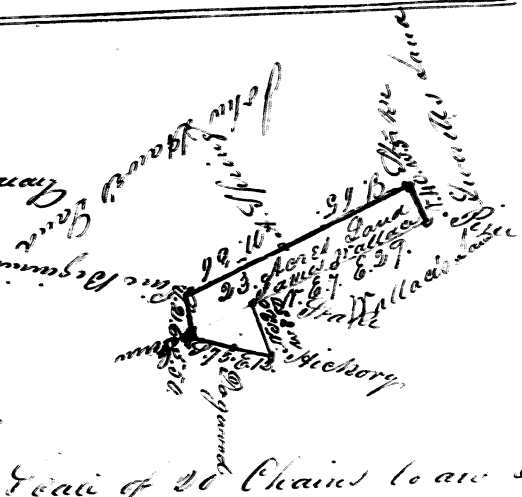

Scale of 20 Chains to an Inch

Georgia Jackson County

Warrant dated 3rd day
 of March 1835
 Surveyed 11th March 1835
 Advertised 13th March 1835
 Certified By Simon
 Harrison C.L.C.

John M. Holladay
 Robert M. Holladay

Scale 20 ch: to an Inch

