

Scale of 10 Chains to an inch
 Georgia Hall County
 Warrant Dated 3rd Sept 1831
 Surveyed 3rd Sept 1832
 Advertised 1st Oct 1832
 By
 Eli W. Cornell, Esq.
 Joel H. Hulley, Esq.
 Sittston Blair

Scale
 Be
 Mar
 Sur
 Adv
 James
 John

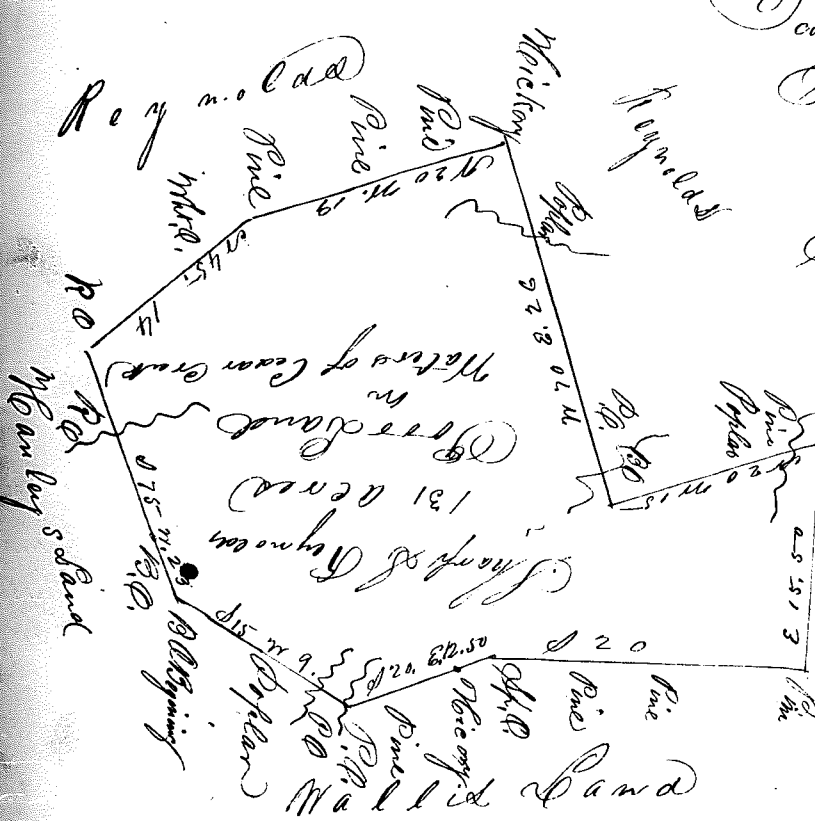

Scale of 10 Chains to an inch
 Georgia Hall County
 Warrant Dated 6th Sept 1831
 Surveyed 16th January 1832
 Advertised 18th January 1832
 By
 Benjamin Griffith, Esq.
 Wm. McCallister, Esq.
 John Reynolds, Esq.

Scale
 Be
 Mar
 Sur
 Adv
 James
 John

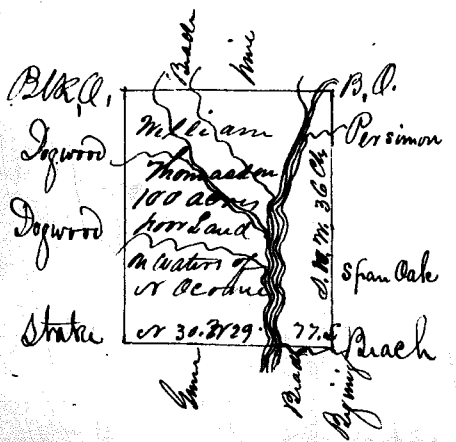

Scale of 20 Chains to an inch
 Georgia Hall County
 Warrant Dated 1st Jan 1831
 Surveyed 14th January 1832
 Advertised 14th January 1832
 By
 Saml. H. McCutcheon, Esq.
 Gallant Flyg, Esq.
 Alexander Crawford

Scale
 Be
 Mar
 Sur
 Adv
 James
 John