

Georgia
 Gwinnett County
 Warrant dated Mar 3, 1823
 Surveyed 24, 17 Mar 1823
 By William Matthews & s
 John Hill & c
 James Hill & c

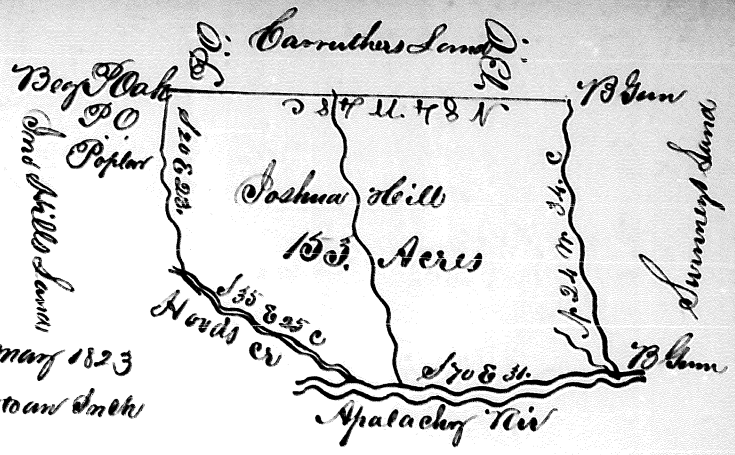

Advertised 23 May 1823
 Scale 20 chains to an Inch

Georgia
 Gwinnett County
 Warrant dated 2, June 1823
 Surveyed 10, June 1823
 Advertised 13, June 1823
 By William Matthews & s
 J Saughbridge & c
 J Brimwell & c

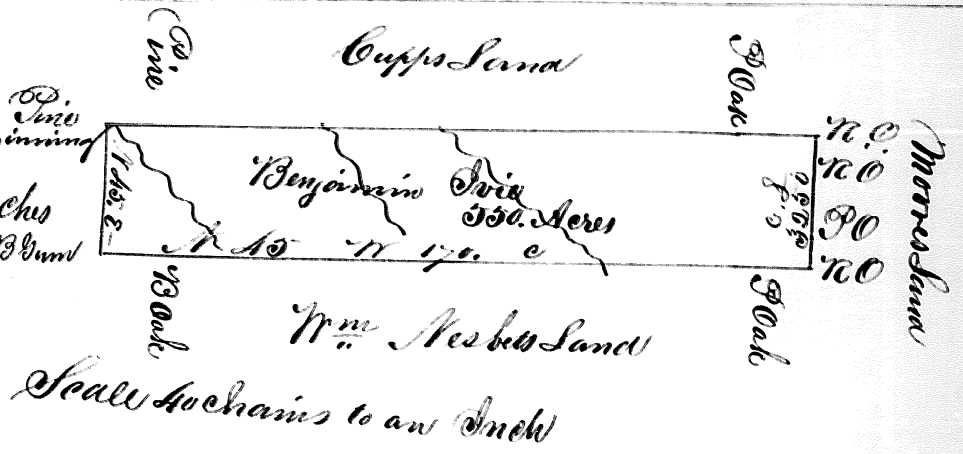

Scale 40 chains to an Inch

Georgia
 Gwinnett County
 Warrant dated 2, June 1823
 Surveyed 12, June 1823
 Advertised 13, June 1823
 By William Matthews & s
 H Lamp & c
 W. Hall & c

