

81. Scale of 20 chs. to an inch Part of Survey of Land

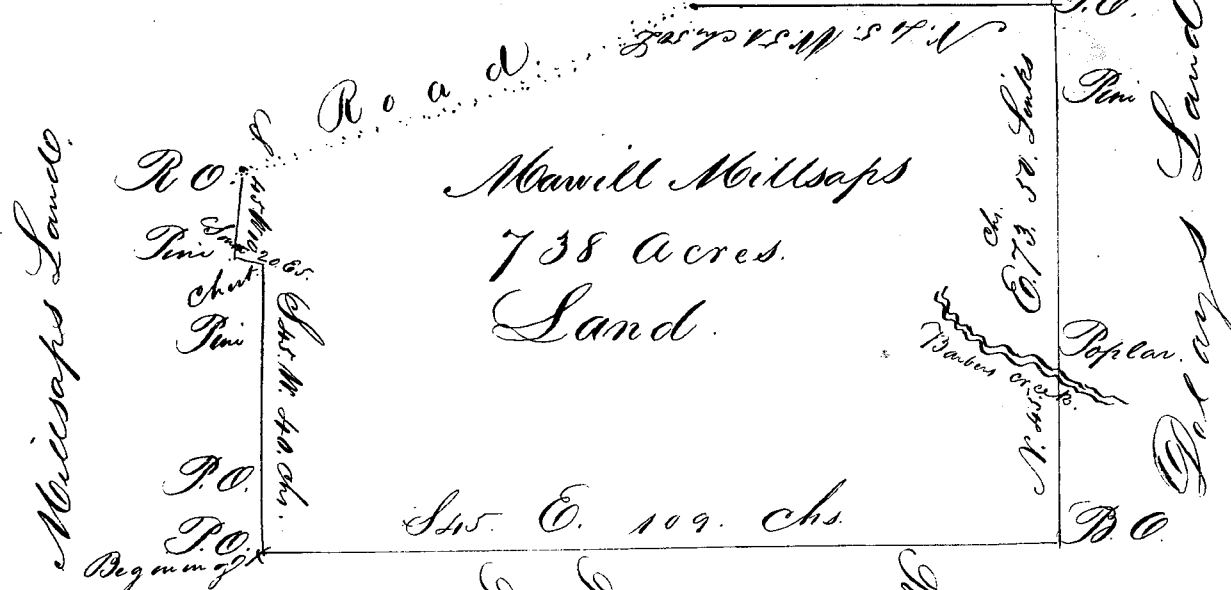

Georgia Jackson County
 Millsaps & Harris Land
 Warrant Dated 2nd April 1838. and
 Surveyed 28th April 1838. By
 Jeremiah Spence }
 James Dukes } C.S.
 Filmon Harrison C.S.

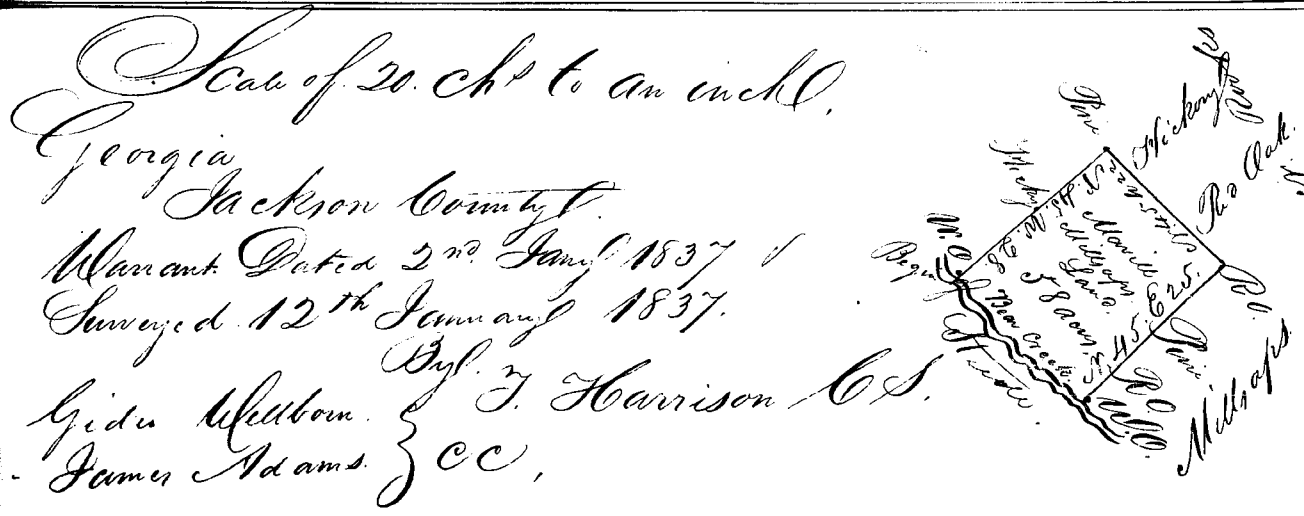
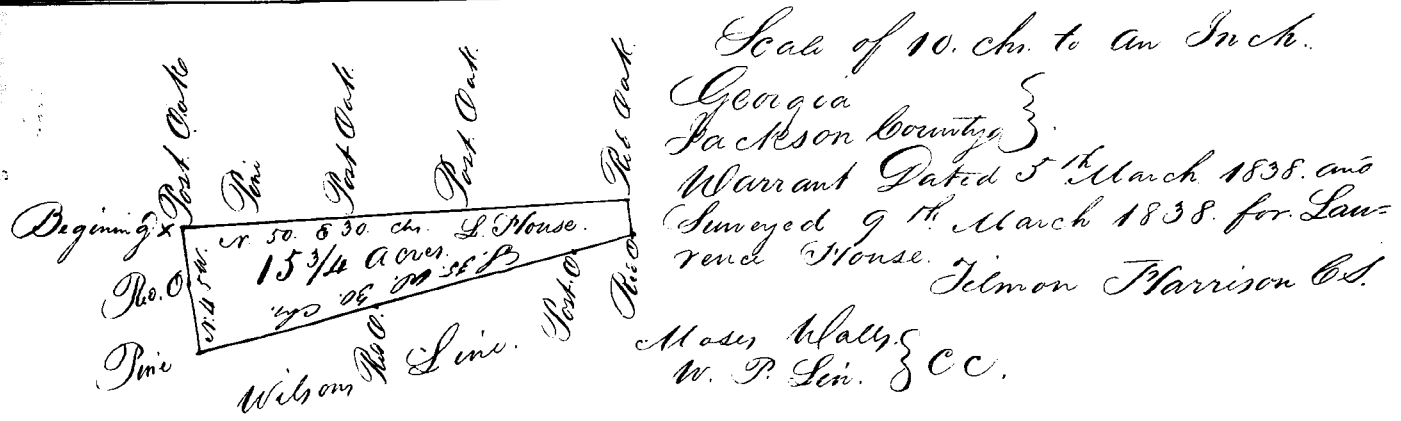

Georgia Jackson County
 Warrant Dated 2nd Jan'y 1837
 Surveyed 12th Jan'y 1837.
 By J. Harrison C.S.
 Gideon Shelton }
 James Adams } C.C.