

Scals of 10 Chains for Lynch.
 Warrant dated 1st June 1852.
 Surveyed 18th do 1852.
 Advertised 19th do 1852.
 Executed By Philip Stinchcomb C.
 Surgeon Smith
 Joseph Dunien J. C. C.
 Georgia Wiltan County.



Scals of 20 Chains for Lynch
 Warrant dated 7th Sept 1852.
 Surveyed 17th do 1852.
 Advertised 18th do 1852.
 Executed By Philip Stinchcomb C.
 Jackson Cook
 Geo W M Dunien J. C. C.
 Wiltan County Geo



Scals of 10 Chains for Lynch Warrant dated 11th July 1851.
 Georgia Richmond County.
 Surveyed 30th Nov 1852.
 Advertised 28th Dec 1852.
 Executed By A. W. Allen C.
 Perry Winters
 Jerry Winters J. C. C.

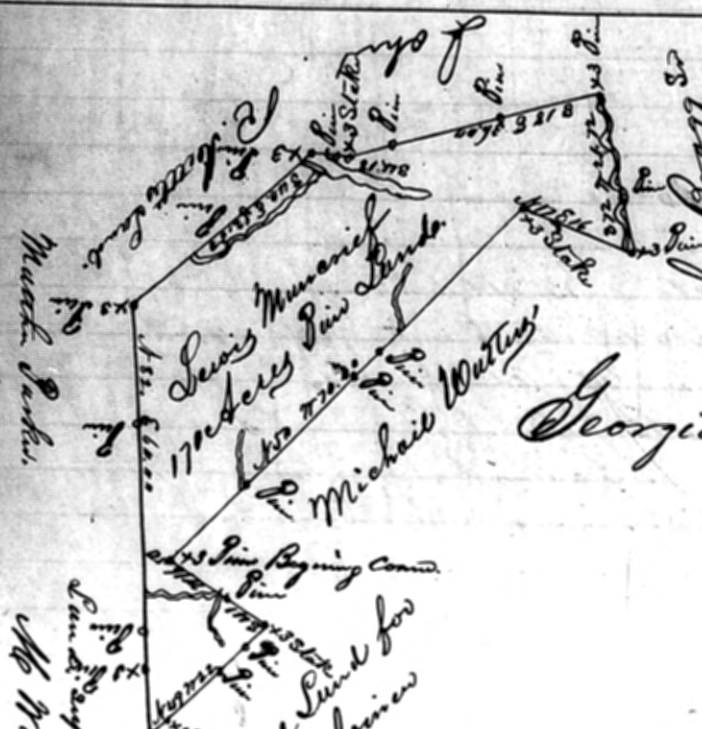

Scals of 20 Chains for Lynch
 Warrant dated 1st June 1846.
 Surveyed 2nd do 1847.
 Advertised 3rd do 1847.
 Executed By W. W. Munnally P. S.
 Lewis Muncrief
 Angus Vickery J. C. C.
 Georgia Sevier County.