

Lucas Stevens land

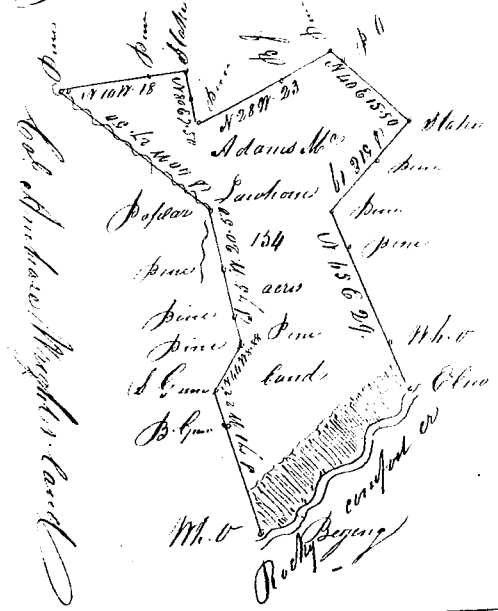

Adam also Sawhane

Georgia
 Jefferson County
 Warrant dated 1st Sept 1828
 Surveyed 2nd Sept 1828
 By Henry B. Kidd C. C.
 Blapergans Thomas C. C.
 John Mc Sawhane
 Seats of 20 Acres per Acre

Lucy



Georgia Jackson County

Warrant dated 7th April 1828
 Surveyed 12th April 1828
 By William Bell C. C.
 Edinger Barber C. C.
 John Lucy
 Seats of 20 Acres per Acre

Efferson land