

442

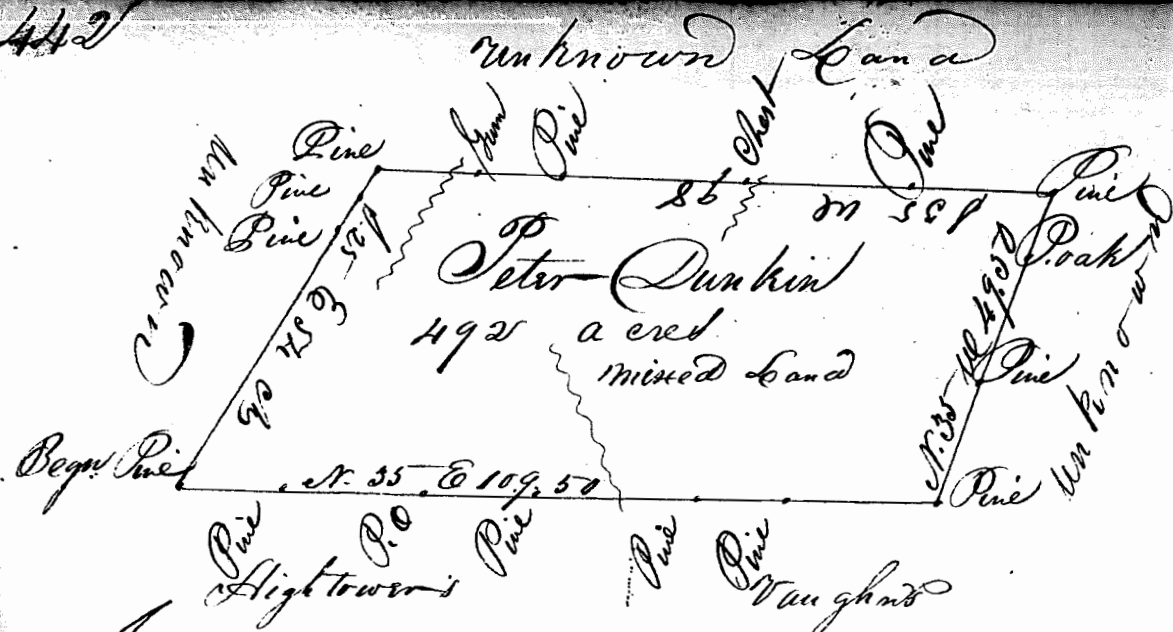

Jackson County

Scale of 20 chs per Inch

Warrant dated 1<sup>st</sup> and Surveyed on the 3<sup>rd</sup> Decr. 1829

By William Bell Esq

Robing Vaughn 3<sup>rd</sup> J.C. Advs 15<sup>th</sup> Decr. 1829  
Thomas Dunkin 3<sup>rd</sup>

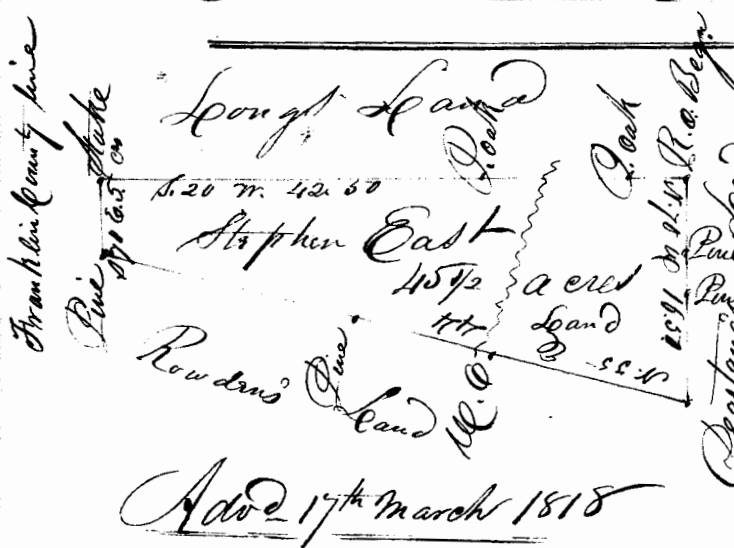

Scale of 20 chs per Inch

Jackson County

Warrant dated 1<sup>st</sup> and Surveyed the 2<sup>nd</sup> Decr. 1817

By Joseph T. Cunningham Esq

A. Wiley Esq  
S. East 3<sup>rd</sup>

Advs 17<sup>th</sup> March 1818

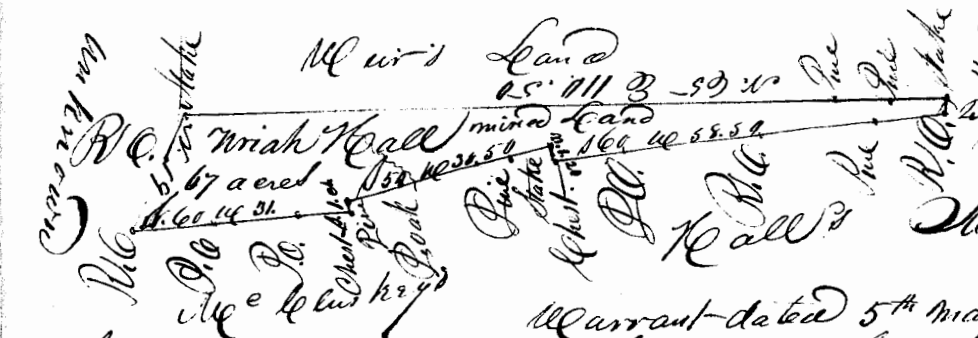

Scale of 20 chs per Inch

Jackson County

Warrant dated 5<sup>th</sup> May 1828 Surveyed on the 10<sup>th</sup> July 1828

By William Bell Esq

Joseph Boggs 3<sup>rd</sup> J.C. Advs 14<sup>th</sup> July 1828  
Wm Le Parr 3<sup>rd</sup>

Seale  
Jackson  
Warrant  
Survey  
James  
John

Jackson  
Burrell  
Mc

Seale  
Jack  
Warrant  
Survey

Thomas  
Richard