

No. 677
 Jackson County
 Warrant dated the 6th of October 1800
 and Surveyed the 24th of October 1800
 By John Sawright Deput. S.
 Certified by Jos. M. Cutchen City S.
 Advertised the 1st of November 1800
 Esther Mobley & }
 William Hindrick } C. C.
 Scale 20 chains to an Inch.

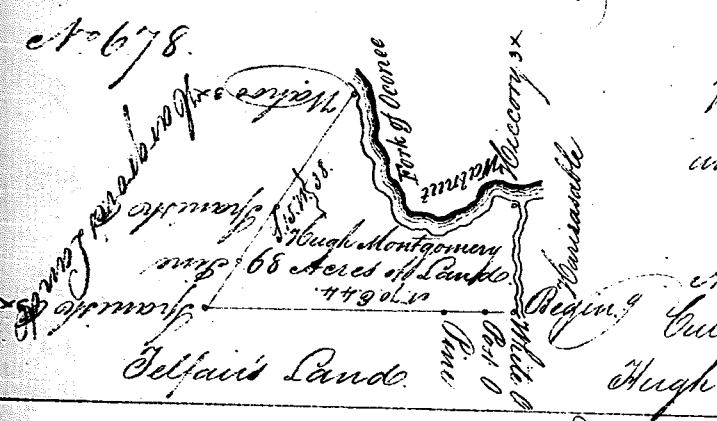

No. 678
 Jackson County
 Warrant dated the 3^d of January 1803
 and Surveyed the 11th of January 1803
 By H. Montgomery City Sur.
 Advertised the 13th of April 1803
 Culver Clements }
 Hugh Montgomery } C. C.
 Scale 20 chains to an Inch.

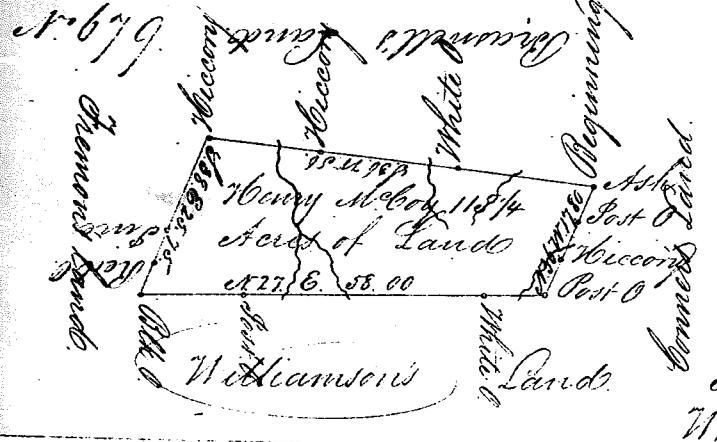

No. 679
 Jackson County
 Warrant dated the 1st of April 1799
 and Surveyed the 2^d of April 1799
 By Edw. Moore Deput. Sur.
 Certified by Jos. M. Cutchen City Sur.
 Advertised the 28th of June 1800
 Abner McCoy }
 W. Simmons } C. C.
 Scale 20 chains to an Inch.

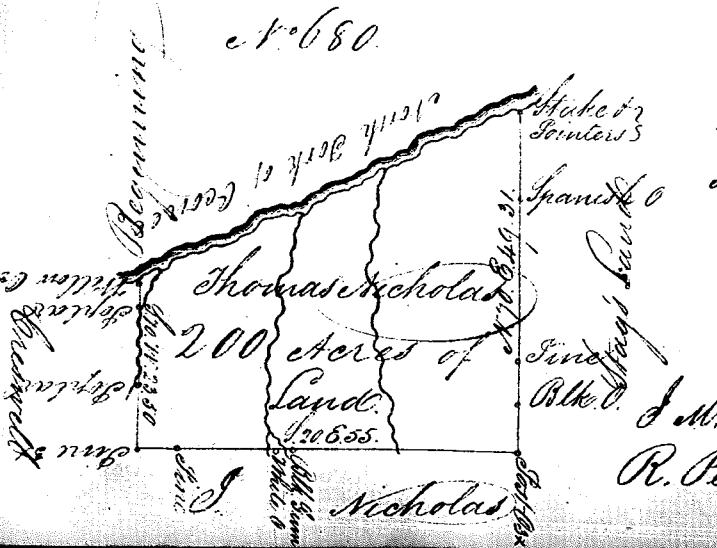

No. 680
 Jackson County
 Warrant dated the 4th of Novem^r 1805 and
 Surveyed the 7th of November 1805
 By Jos. M. Cutchen
 Certified by Hugh Montgomery City Sur.
 Advertised the 31st of March 1806
 J. M. Cutchen }
 R. Pettyjohn } C. C.
 Scale 20 chains to an Inch.