

Franklin County Warrant
 dated 1st May 1780. Surveyed the 16th
 May 1780 by Wm. Hay Esq. Cut^d by
 John Gorham C.S.
 See 20 Chs per Inch 1725

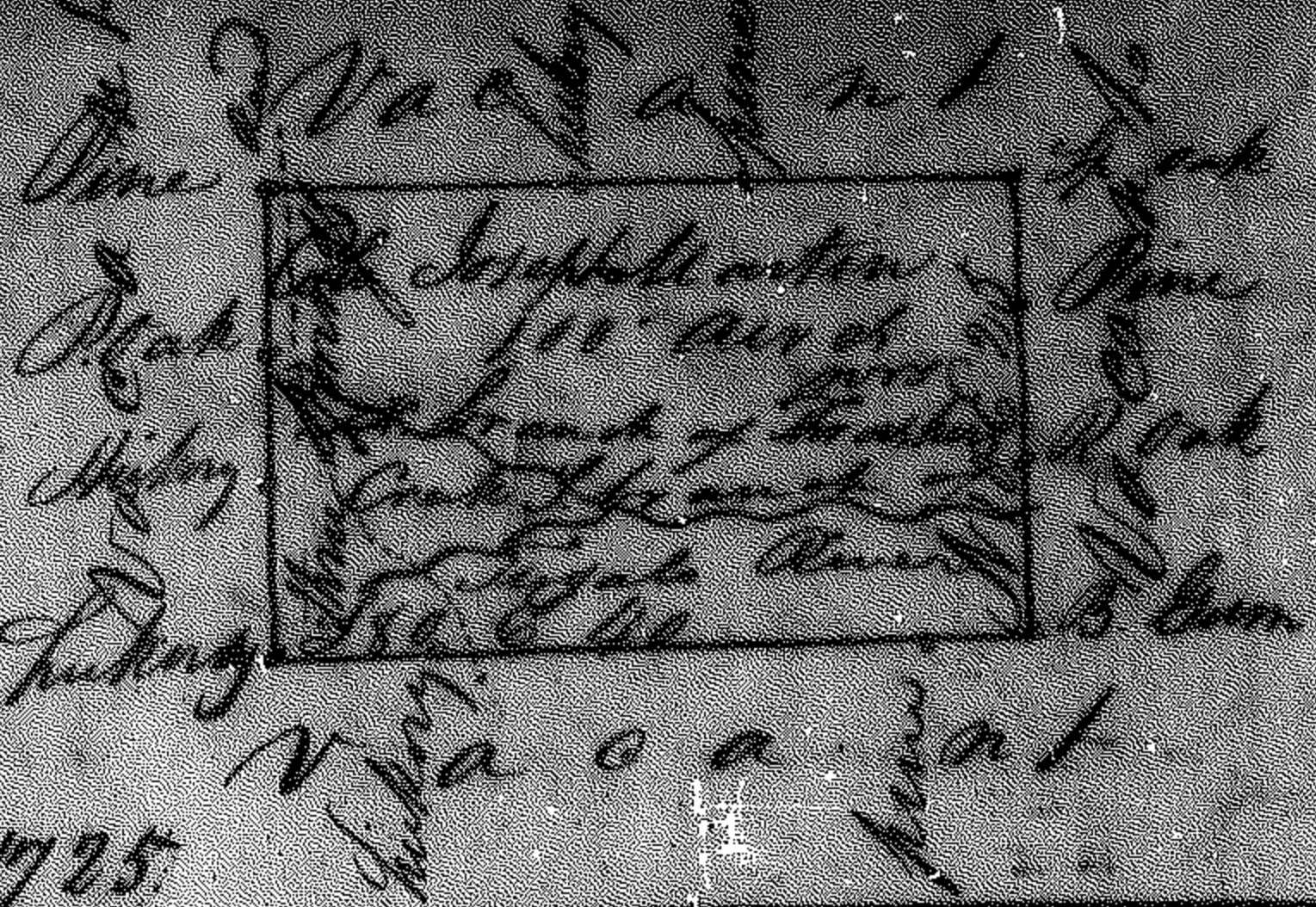

Franklin County Warrant
 dated 1st May 1780. Surveyed
 21st May 1780 by Wm. Hay Esq.
 Cut^d by John Gorham C.S.
 See 30 Chs per Inch 1725

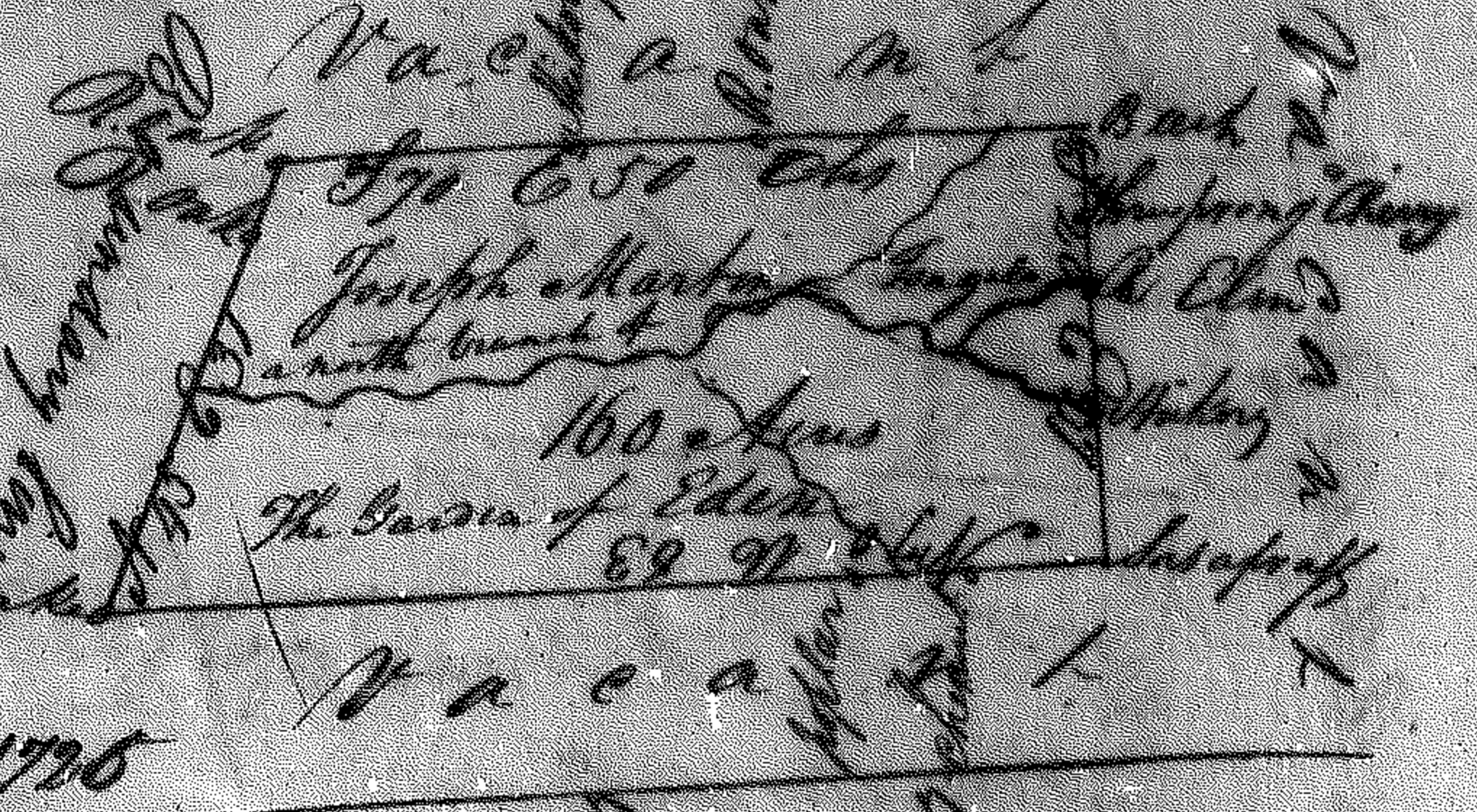

Franklin County
 Warrant dated 17th May 1784
 Surveyed 30th June 1784 by
 Ezekiel Offutt D.S. Cut^d by
 John Gorham C.S.
 See 30 Chs per Inch 1727

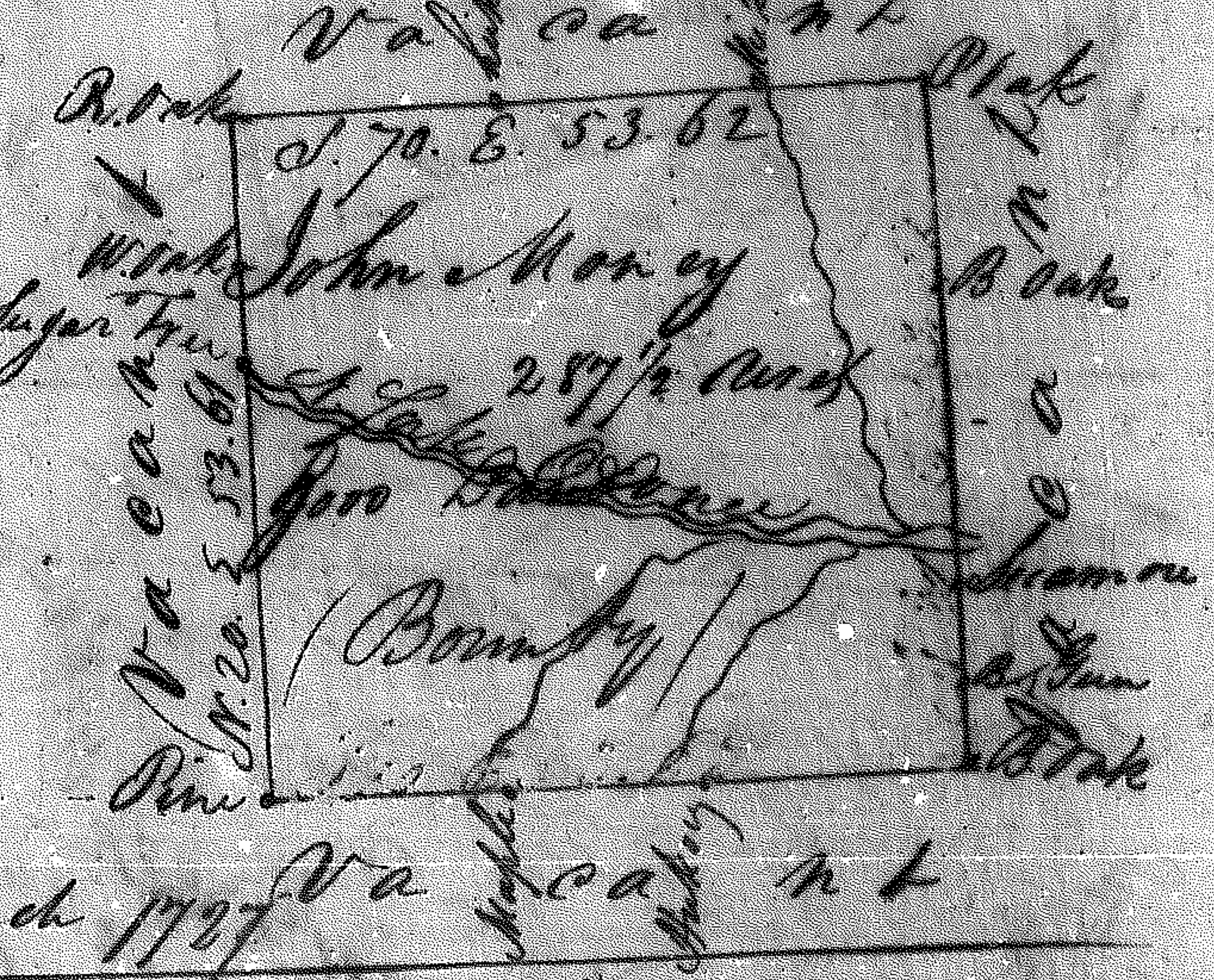

Franklin County Warrant
 dated 17th May 1784. Surveyed
 10th August 1784 by Ezekiel Offutt
 Cut^d by John Gorham C.S.
 See 30 Chs per Inch
 1728



Franklin County Warrant dated 27th May
 1787. Surveyed August 10th 1790 by
 St. Gardner Esq. Cut^d by John Gorham C.S.
 See 40 Chs per Inch
 1729

