

Scale 20 Chains to an Inch
 Georgia Warrant dated 6th March 1826
 Habersham County Surveyed 18th Feb 1827 for
 John Lyons who resides in that State a tract
 of land containing thirty five and a half acres
 bounded by Shellen's Herasher and vacant land
 Adjudged 14th Feb 1827

By Thomas A Wood Esq
 General Clerk of Ct

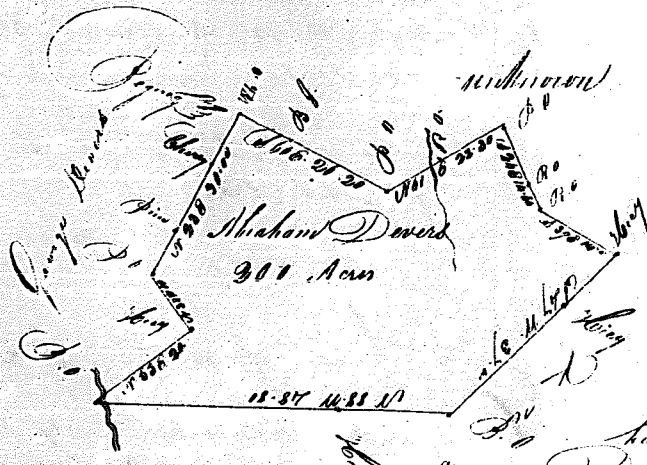

Scale 20 Chains to an Inch
 Georgia Habersham County

Warrant dated 14th March 1828
 Surveyed 8 March 1828 for
 Abraham Drovers who resides in this
 State a tract of land containing two
 hundred acres bounded by George
 Drovers vacant and unknown land

By Thomas A Wood Esq
 General Clerk of Ct

Daniel McKracken Esq
 Genl. Clerk of Ct
 Adjudged 14th Feb 1829

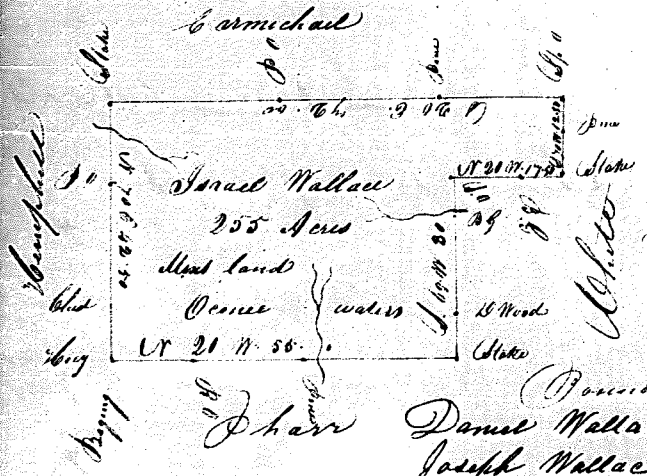

Scale 20 Chains to an Inch

Georgia Warrant dated 1 April 1833
 Jackson County Surveyed 5 April 1833
 for Israel Wallace who resides in
 this State a tract of land containing
 two hundred and fifty five acres
 bounded by White's barndickland Pharr and Humphreys

By John C. Johnson Esq
 Adjudged 10th April 1833
 Daniel Wallace Esq
 Joseph Wallace Esq