

Scale 5 chains to an inch

Georgia
 Jackson County
 Warrant dated 5th Jan'y 1835
 Surveyd 7th Jan'y 1835
 By John C. Palmers Esq
 Conf'd By Silvan Harrison Esq
 Advd 4th March 1835

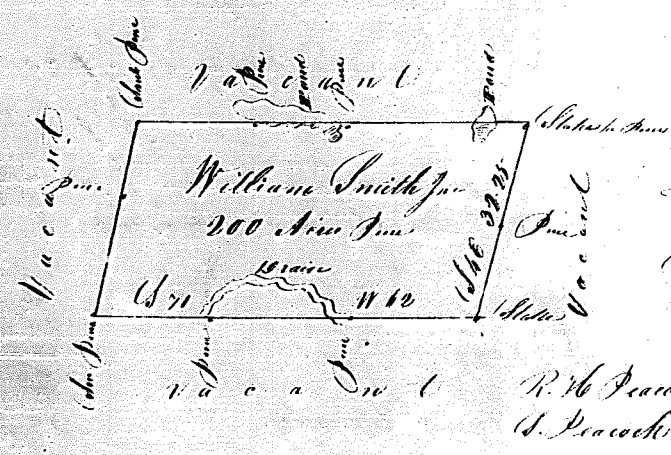

Scale 20 chains to an inch
 Georgia
 Liberty County
 Warrant dated 3rd March 1828
 Surveyd 20 Nov 1828
 By A. G. Whittington Esq
 Advd 3rd Dec 1828

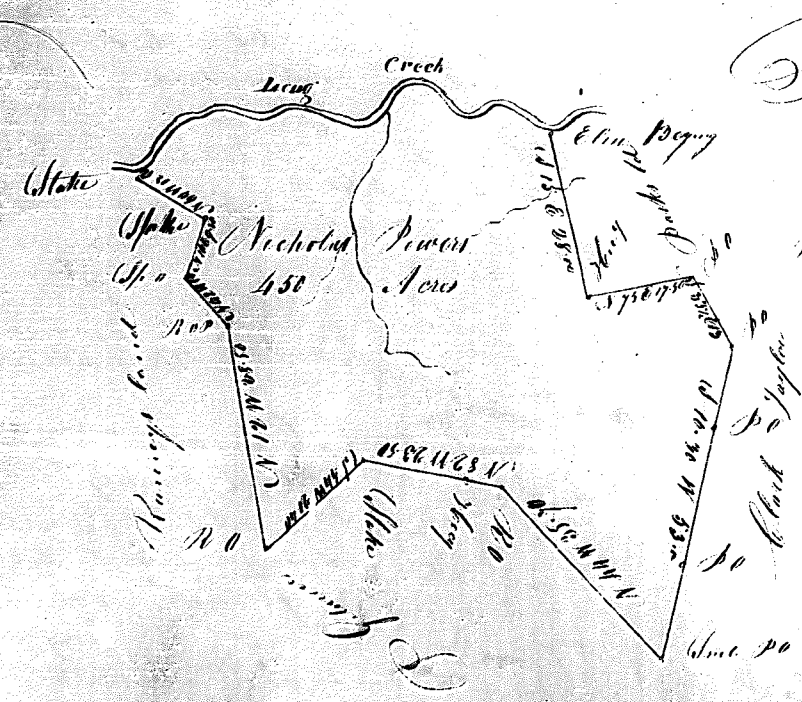

Scale 20 chains to an inch

Georgia
 Oglethorpe County
 Warrant dated 5th Nov 1833
 Surveyd 11th Dec 1833
 By William Jewell Esq
 Advd 2nd Jan'y 1834
 Abraham Thomas Esq
 Charles Mottant Esq