

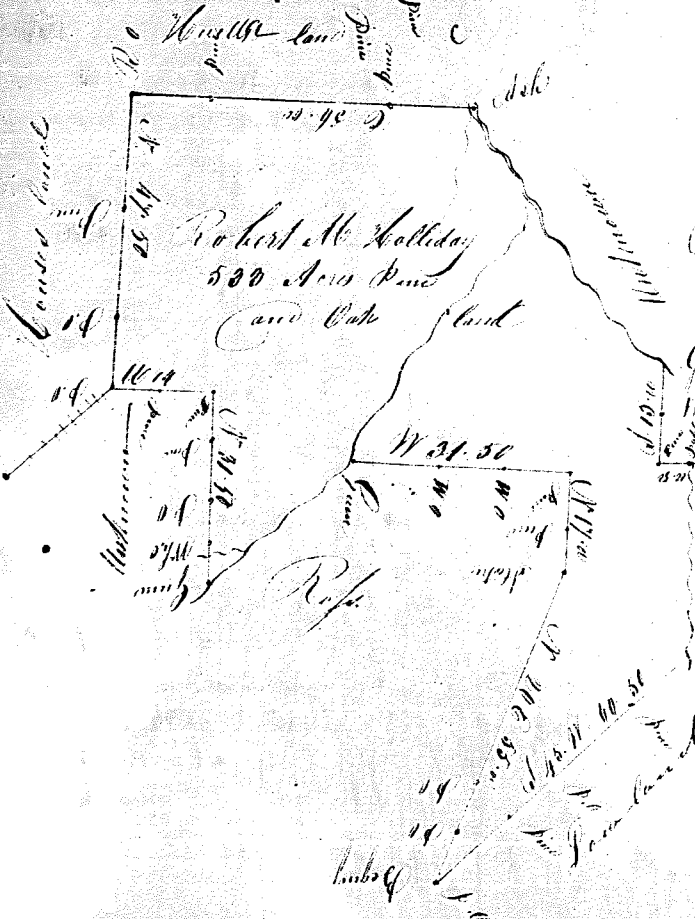

Scale of 20 chains to an inch
 Georgia
 Franklin County
 Warrant dated 4th Decr 1822
 Surveyed 7th Decr 1822
 for Thomas King
 By Benjamin Stewart Esq
 Admitted 3rd Aug 1823

James King Esq
 John Stubbs Esq



Scale 20 chains to an inch
 Georgia
 Jackson County
 Warrant dated 1st day July 1822
 Surveyed 1st day of July 1822
 for Robert M. Holliday
 By William Bell Esq
 Berry House Esq
 Wiley Ross Esq
 Admitted 9th July 1822