

Jackson County
 Warrant dated 6th July 1812
 Surveyed 16th April 1813
 By J. Cunningham C.S.
 Advertised 23rd July 1816
 Sean Pearce,
 Mark Doff & Co
 Scale of 20 chs to an inch

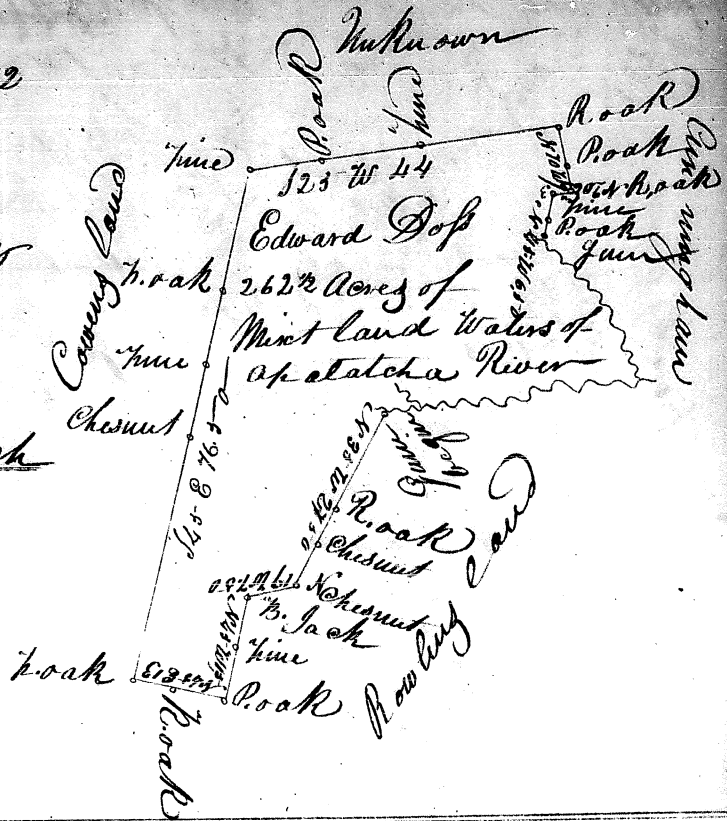

Jackson County
 Warrant dated 2nd January 1815
 Surveyed 7th January 1815
 By Jos. J. Cunningham C.S.
 Advertised 13th February 1815
 A. Nichol & Co
 J. Doff & Co
 Scale of 20 chs to an inch

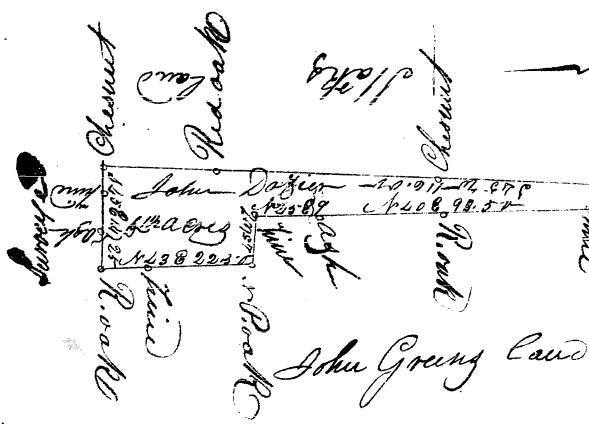
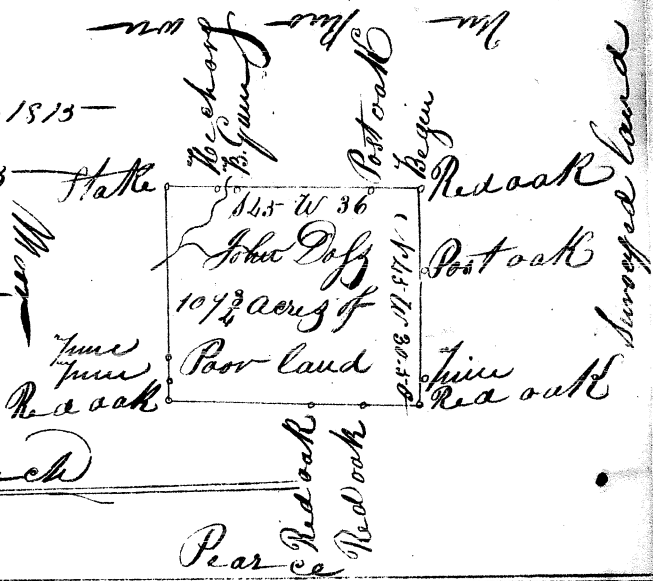

Jackson County
 Warrant dated 7th October 1811
 Begun by Dogwood & surveyed
 12th Oct. 1811; by J. Cunningham C.S.
 Advertised 8th June 1812
 William Gideon &
 George Sway & Co
 Scale of 30 chs to an inch