

Jackson County.

Warrant dated 5th June 1815.

Surveyed 5th July 1815.

By Joseph J. Cunningham C.S.

J. Conway } b.c.
W. Chamley }

Scale 20 Chs for Incho.

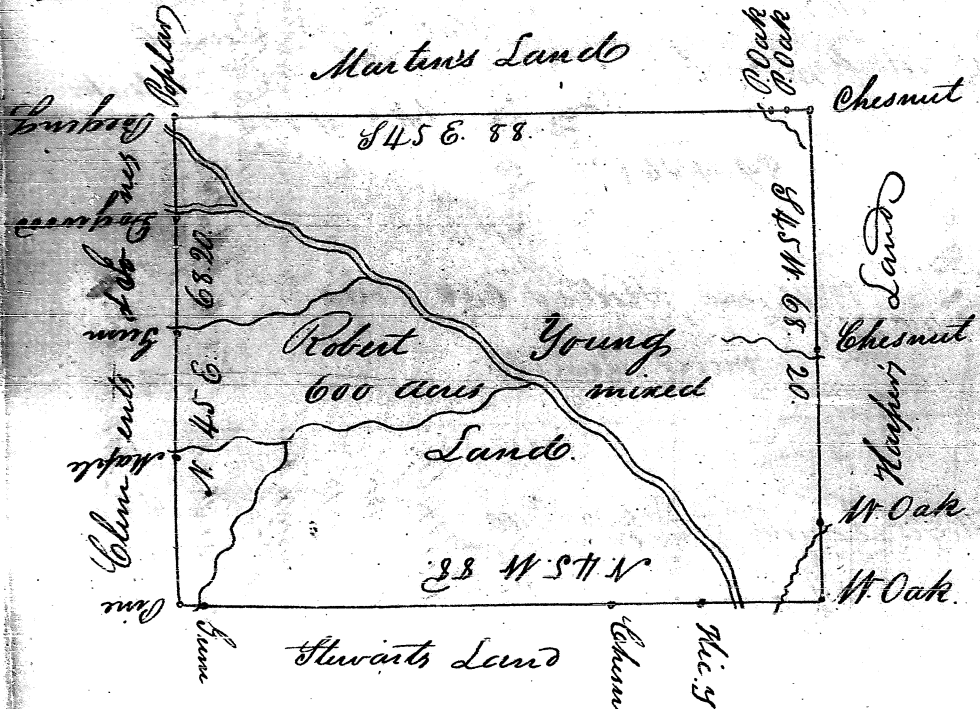

Jackson County.

Warrant dated 6th November 1815.

Surveyed 8th November 1815.

By Joseph J. Cunningham C.S.

J. Dunman } b.c.
J. Collins }

Scale 20 Chs for Incho.