

Clements Land

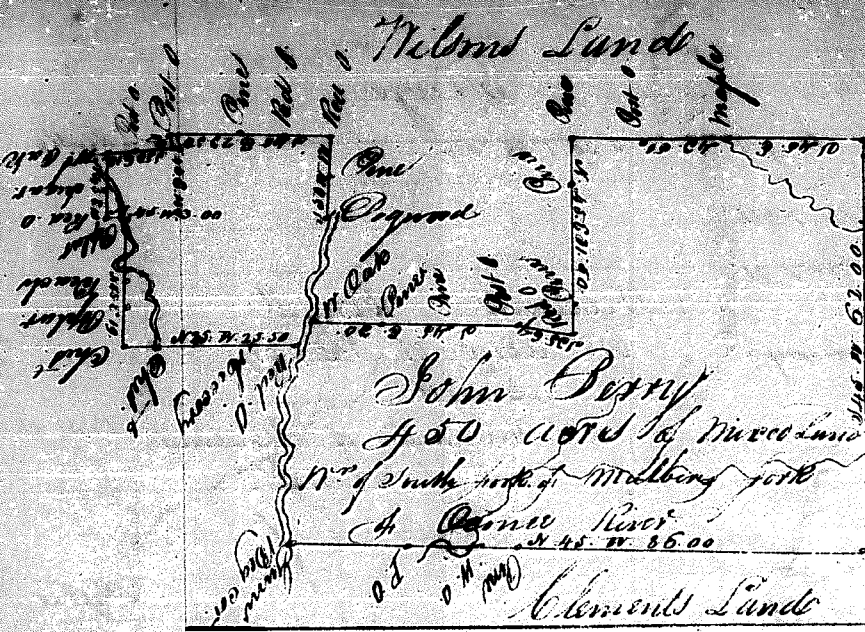

Jackson County
 One Warrant dated 1st
 One March 1810 and surveyed
 One 15th March 1810
 By W. Cunningham Esq
 Thomas Wilson
 Andrew Langley & Co
 Advertised 29th March 1810
 stated scale of 20 chs per inch.

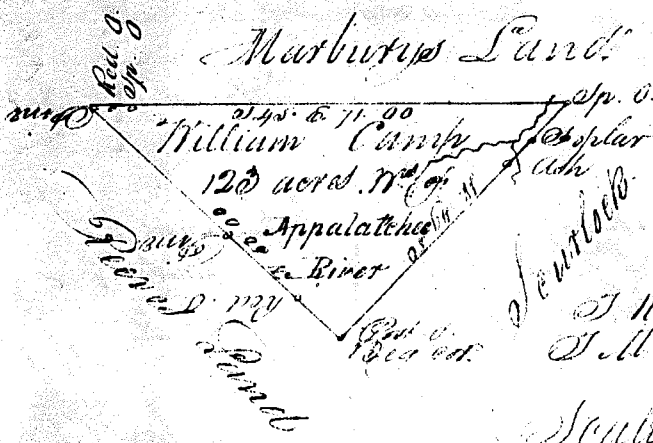

Jackson County
 Warrant dated 5th June
 1810 and surveyed 12th
 September 1810
 By Jos. Cunningham Esq
 J. Reeves
 T. M. Cunn
 Advertised 1st April 1819.
 Scale of 20 chains per inch.



Jackson County
 Warrant dated 2nd
 January 1810 and
 surveyed 5th
 January 1810
 By W. Cunningham
 D. Strickland & Co
 Red of D. Strickland
 Advertised 7th Jan. 1810
 Scale of 20 chs per inch.