

Grand Land

Jackson County  
Warrant dated 7<sup>th</sup> March  
1808 and surveyed 9<sup>th</sup> March 1808.  
By J. Cunningham & Co

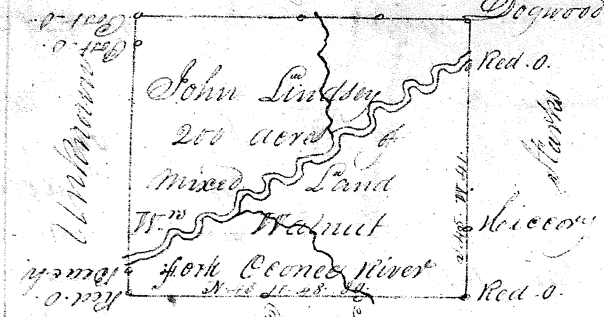

William Adams & Co  
John Brown & Co  
Advertised 5<sup>th</sup> July 1808.

Purcell Land

Scale of 20 chains per inch

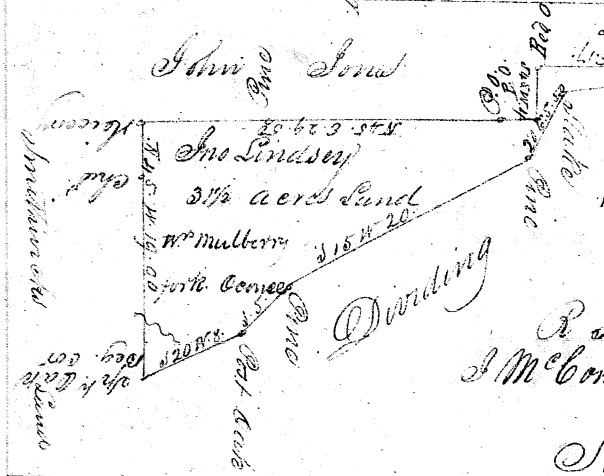

Jackson County  
Warrant dated 5<sup>th</sup> June 1810  
and surveyed 3<sup>rd</sup> July 1810  
By J. Cunningham & Co  
R. Smith & Co  
J. McConnell & Co

Advertised 16<sup>th</sup> November 1810  
Scale of 10 Chains per inch

Montgomery

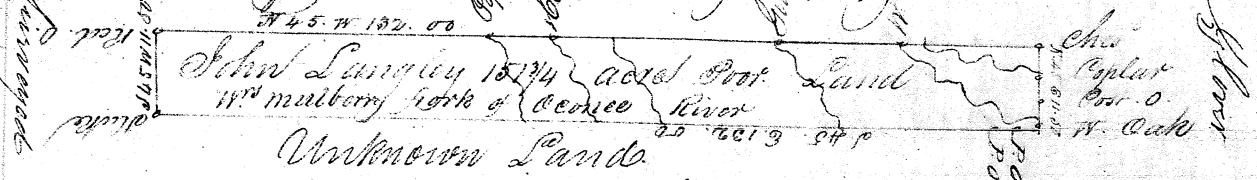

Jackson County  
Warrant dated 5<sup>th</sup> June 1815 and surveyed 19<sup>th</sup> July 1815  
By J. Cunningham & Co  
J. Appleby & Co  
J. McConnell & Co  
Advertised 1<sup>st</sup> August 1815  
Scale of 20 chains per inch

Montgomery

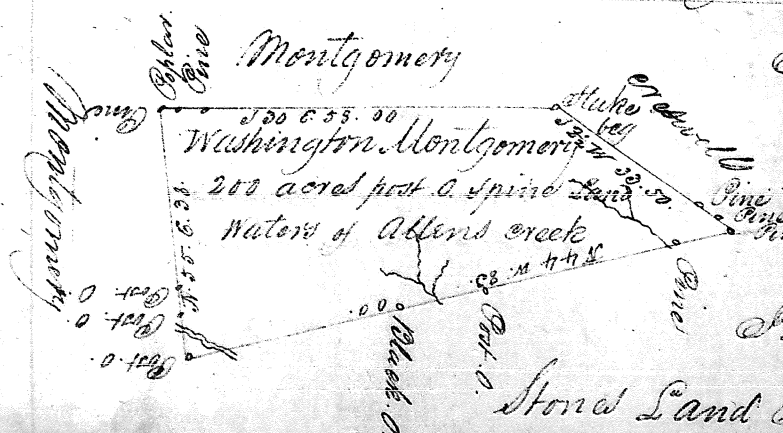

Jackson County  
Warrant dated 5<sup>th</sup> Dec<sup>r</sup>  
1802 and surveyed 24<sup>th</sup>  
December 1802  
By W. Montgomery & Co  
W. Montgomery & Co  
S. Montgomery & Co  
Advertised 27<sup>th</sup> February 1804  
Stone Land Scale of 20 chains per inch