

Vacant

Emanuel County

Warrant dated 6th September 1813
and Surveyed 15th March 1815
By Charles Thiggin D.S.
Certified by T. Thiggin C.S.
Josiah Drew Jun 3/66
Josiah Drew Jun 3/66
Advertised 15th March 1815
Scale of 20 Chains to an Inch

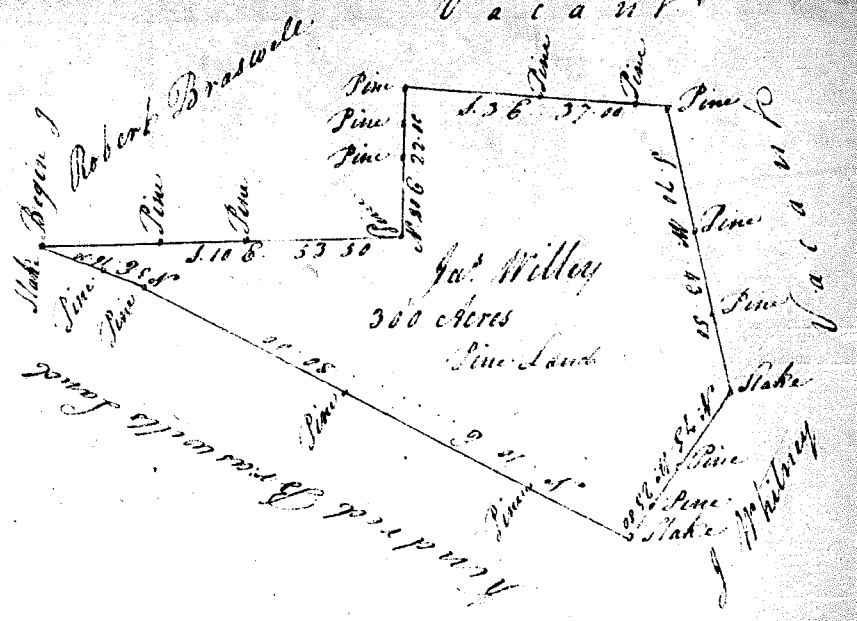

Jackson County

Warrant dated 4th March 1811 and Surveyed 8th March 1811
By J. Cunningham C.S.
Samuel Fallon 3/66
John Postwick 3/66
Advertised 20th July 1811
Scale of 10 Chains to an Inch

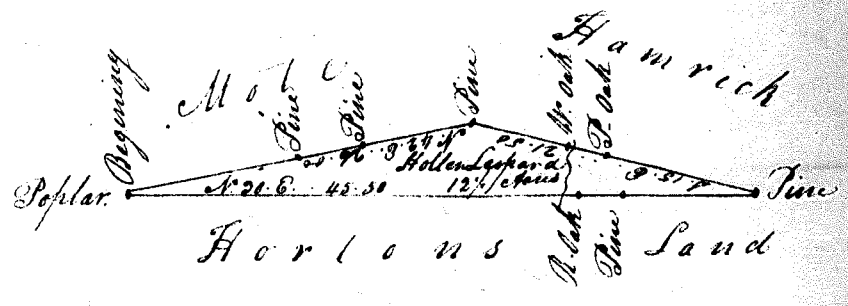

Jackson County

Warrant dated 15th June 1815 and Surveyed 16th May 1817
By Joseph T. Cunningham C.S.
R. Bearden 3/66
Rowlin Bearden 3/66
Advertised 21st September 1817
Scale of 20 Chains to an Inch

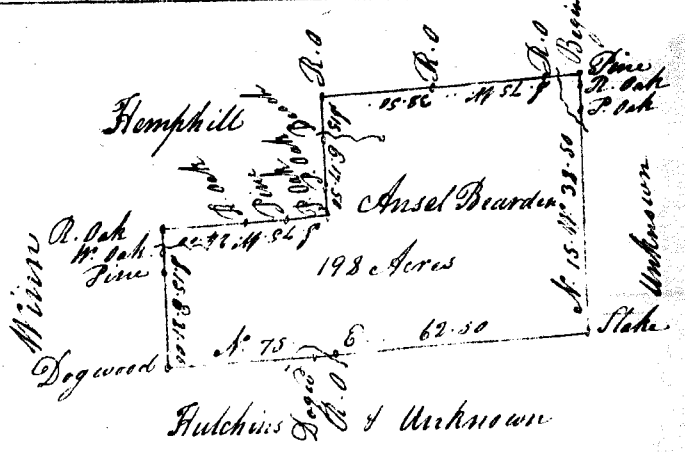

Jackson County

Warrant dated 6th January 1812 and Surveyed 16th January 1812
By J. Cunningham C.S.
Thomas Stiblack 3/66
John Wallis 3/66
Advertised 31st March 1812
Scale of 10 Chains to an Inch

